



## **Public Notice**

### CATEGORICAL EXCLUSION DRINKING WATER STATE REVOLVING FUND LOAN

The Nevada Administrative Code in Sections 445A.6758 to 445A.67612, inclusive, outlines the environmental review procedures to be followed by the Division of Environmental Protection (NDEP) to meet the requirements of the National Environmental Policy Act. In accordance with these procedures, NDEP intends to issue a categorical exclusion for the Truckee Meadows Water Authority water project. The project will utilize funds from the Drinking Water State Revolving Loan Fund (DWSRF).

Project Name: Verdi Pipeline Extension & System Consolidations

Project No.: #37 & #38 Year 2018 Priority List

Applicant: Truckee Meadows Water Authority

Estimated Drinking Water State Revolving Fund Assistance: \$1,000,000

The Truckee Meadows Water Authority (TMWA) is a not-for-profit, community-owned water utility that serves the cities of Reno and Sparks and surrounding areas of Washoe County. This project involves extending an 18-inch water main from the new West Meadows subdivision to the River Belle Mobile Home Park and potentially further west on US Highway 40 to serve the existing Verdi Mutual water system. The proposed main extension is part of the overall water supply plan to extend water service to the Verdi area.

NDEP has determined that the projects are eligible for a categorical exclusion under NAC 445A.67583 (2) (d) (1), minor expansion of the existing capacity of the distribution system of a public water system, and may be exempted from further substantive environmental review requirements. The project is also eligible for a categorical exclusion under NAC 445A.67583 (2) (e) because there is sufficient evidence that a significant effect on the quality of the environment is unlikely. The project will have a beneficial effect by ensuring the customers receive water that is safe to drink.

No wetlands, floodplains, agricultural lands, or significant fish or wildlife species or habitat is affected by the project. No national landmarks or property with nationally significant historic, architectural, prehistoric, archeological, or cultural value is affected by the project.

Consultation with appropriate crosscutting agencies will be completed prior to signing a final commitment of financial assistance. Best management practices will be utilized during construction. Documentation supporting these conclusions is available for public examination at the office of the Division of Environmental Protection, 901 S. Stewart St., Suite 4001, Carson City, Nevada.

Comments for consideration on this proposed decision must be submitted by September 12, 2017 to: Michelle Stamates, State Revolving Fund Program, 901 S. Stewart St., Suite 4001, Carson City, NV 89701-5405. Comments may also be submitted by FAX to (775) 687-9510 or by e-mail to [mstamate@ndep.nv.gov](mailto:mstamate@ndep.nv.gov). Questions regarding this notice may be directed to Michelle Stamates at (775) 687-9331. The process of environmental review shall be deemed complete if no comments that the NDEP determines to be significant are received within the time allowed for public comment.

USGS 7.5-MIN TOPO - VERDI, NV

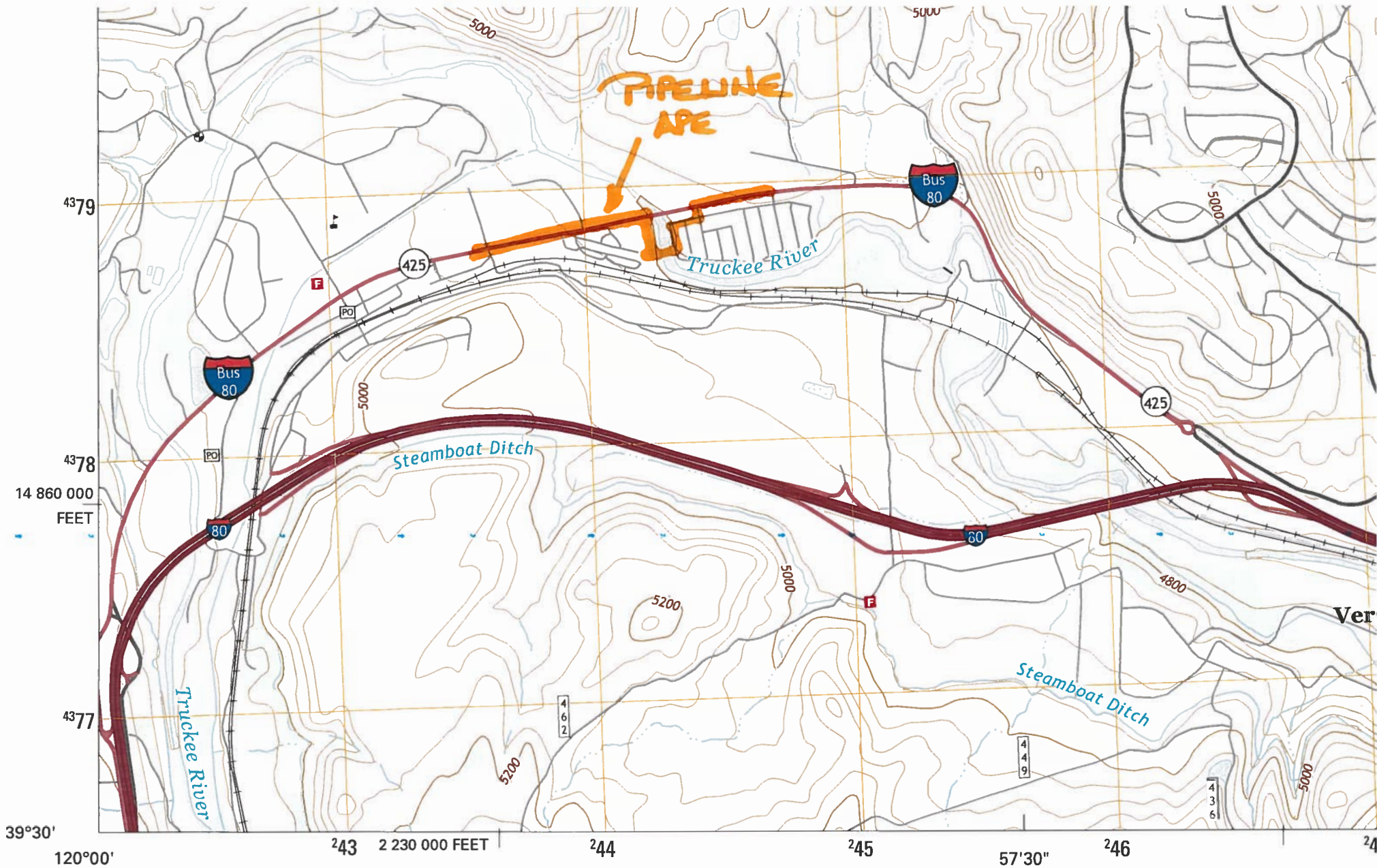

Produced by the United States Geological Survey  
North American Datum of 1983 (NAD83)  
World Geodetic System of 1984 (WGS84). Projection and  
1:62,500 scale. Universal Transverse Mercator, Zone 11N.

PROJECT LOCATION: T-19N, R-18E, SECTIONS 8 & 9