

# STATE OF NEVADA

Department of Conservation & Natural Resources

Brian Sandoval, Governor

Leo M. Drozdoff, P.E., Director

DIVISION OF ENVIRONMENTAL PROTECTION

Colleen Cripps, Ph.D., Administrator

## Public Notice

### CATEGORICAL EXCLUSION DRINKING WATER STATE REVOLVING FUND LOAN

The Nevada Administrative Code (NAC) in Sections NAC 445A.6758 to 445A.67612, inclusive, outlines the environmental review procedures to be followed by the Division of Environmental Protection (NDEP) to meet the requirements of the National Environmental Protection Act. In accordance with these procedures, NDEP has determined that the project described below is eligible for Categorical Exclusion and may be exempted from further substantive environmental review requirements.

Project Name: Drinking Water System Capital Improvement Project

Project No.: No. 64 - 2011 Rev #1 Priority List

Applicant: Gold Country Water Company

Estimated Drinking Water State Revolving Fund Assistance: \$705,000

Gold Country Water Company is located five miles south of Winnemucca and serves the Gold Country Estates, portions of Thomas Canyon Acres, Grass Valley Elementary School, the LDS Church and the Baptist Church. Due to high levels of nitrates in recent tests at Well #1, an additional water source is needed. Gold Country Water Company currently has a back-up or emergency inter-tie to the City of Winnemucca Airport water system. The Drinking Water State Revolving Fund loan project proposed by the Gold Country Water Company includes the purchase of the City of Winnemucca Airport water system, re-equip the wells with new pumps, motors and variable frequency drives, make necessary improvements to the chlorine injection system and replace the existing meter vault with an equivalent length of 8-inch pipe.

The project also includes piping improvements at the Gold Country water system existing Well #1 and Well #2 to improve sanitary seal conditions and allow for pump to waste as required by NDEP. It is also necessary to replace the existing Supervisory Control and Data Acquisition (SCADA) system, as it is more than 10 years old and is no longer supported by the manufacturer. The new SCADA system will allow for flow pacing of chlorine and permit the wells to pump directly to the existing water storage tank for blending.

The project is eligible for a categorical exclusion because it entails the rehabilitation of an existing facility and is unlikely to have a negative effect on the quality of the environment. The construction is minor and will take place on already disturbed land. The project will have a beneficial effect by ensuring the customers receive an adequate supply of water that meets all drinking water standards. Consultation with the State Historic Preservation Office has been initiated. Compliance with section 106 of the National Historic Preservation Act will occur before construction begins.

Documentation to support these conclusions is available for public examination at the office of the Division of Environmental Protection, 901 S. Stewart St., Suite 4001, Carson City, Nevada.

Comments for consideration on this proposed decision must be submitted by July 6, 2012, to:

Michelle Stamates  
Drinking Water State Revolving Fund Program  
901 S. Stewart St., Suite 4001  
Carson City, NV 89701-5405

Comments may be submitted by FAX to (775) 687-9510 or by e-mail to [mstamate@ndep.nv.gov](mailto:mstamate@ndep.nv.gov).  
Questions regarding this notice may be directed to Michelle Stamates at (775) 687-9331.

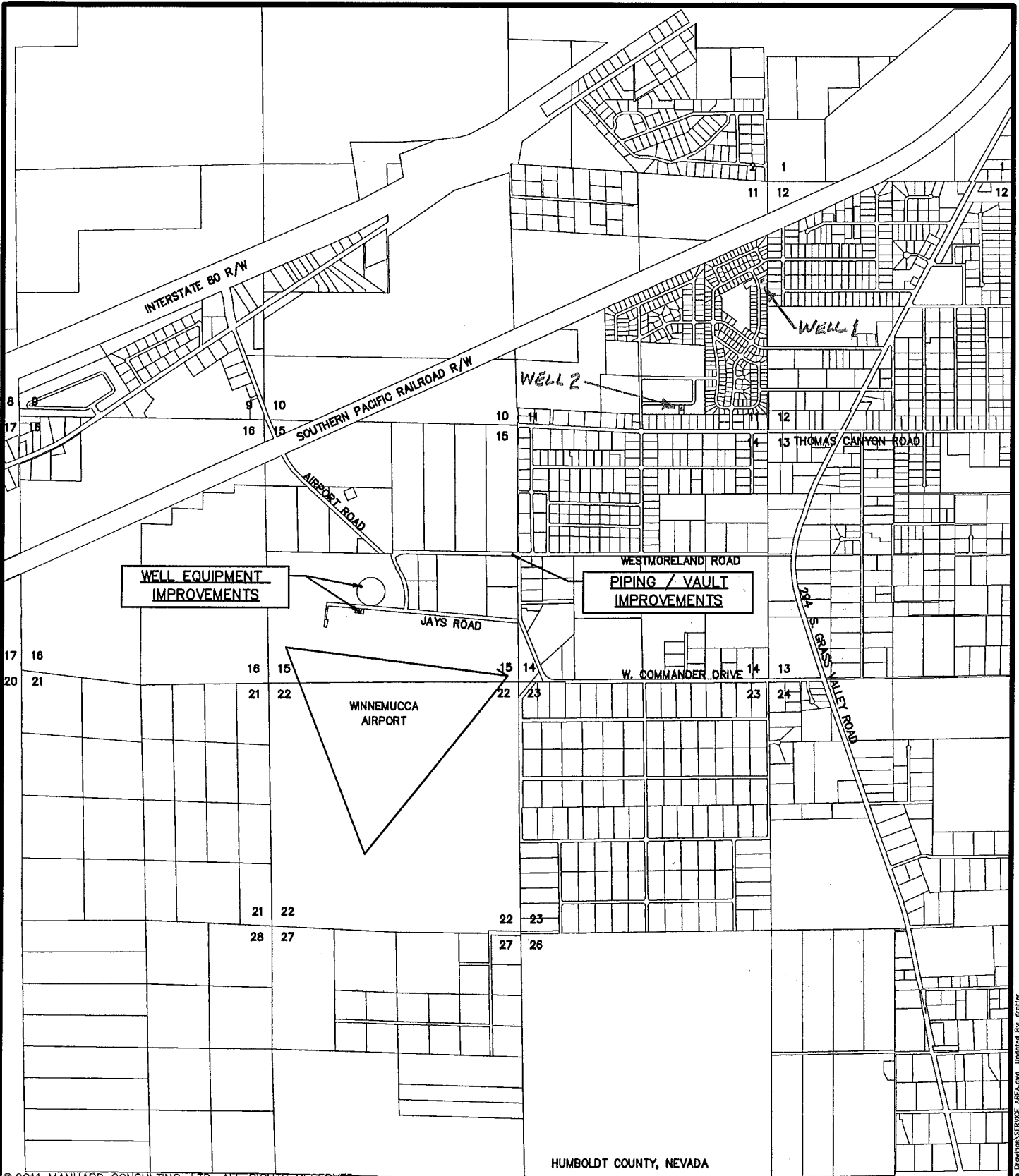

© 2011 MANHARD CONSULTING, LTD. ALL RIGHTS RESERVED

**Manhard**  
CONSULTING LTD

8800 Double R Blvd, Suite 101, Reno, NV 89521 tel: (775) 748-8800 fax: (775) 748-8880 www.manhard.com  
 Civil Engineers • Surveyors • Water Resources Engineers • Water & Wastewater Engineers  
 Construction Managers • Environmental Scientists • Landscape Architects • Planners

Gold Country Water Company	
Humboldt County, Nevada	
Location of Proposed Construction	
PROJ. MGR.: KLJ	SHEET
DRAWN BY: DLR	<b>EXHIBIT F</b>
DATE: OCT 2011	<b>GCWHCN3 110635</b>
SCALE: N.T.S.	

Dwg Name: P:\Location\Wing\Long\Bases Drawings\SERVICE AREA.dwg Updated By: crotter